

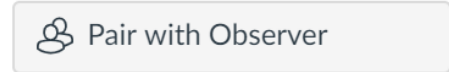
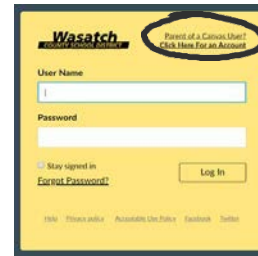

Creating a Canvas Parent Observer Account

You can monitor your child's progress online on Canvas or through the Canvas Parent App.

FIRST: On a COMPUTER

- Visit wasatch.instructure.com (don't just google "Canvas")
 - In the top right-hand corner click 'Parent of a Canvas User?'
 - Create an account
- **Note** Your student needs to generate a pairing code by:**
- Logging into **their** Canvas account,
 - Click their profile icon and then Settings
 - Click Pair with Observer on the right side





 For future reference in logging in, your email address becomes your username.

CANVAS PARENT APP

ANDROID & iOS

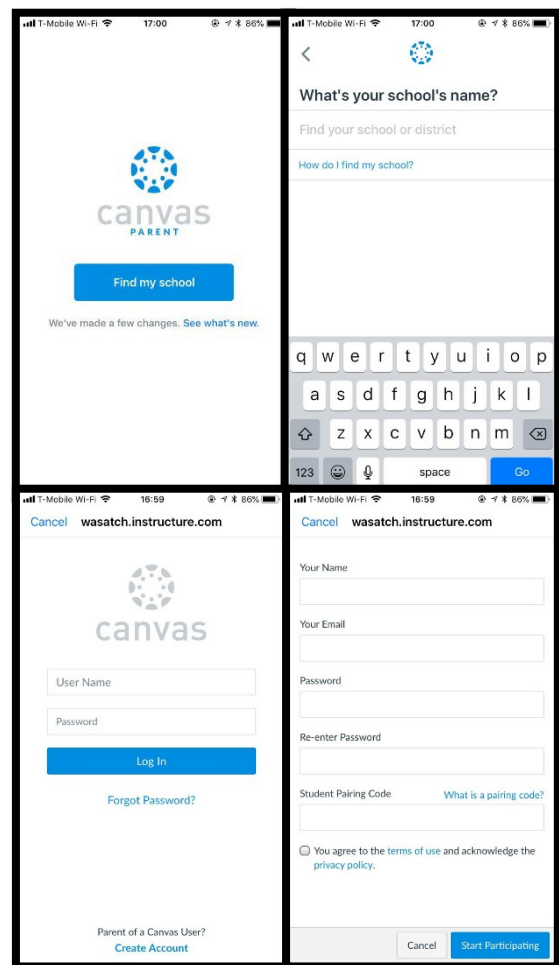
- Download Canvas Parent App and open
- Click 'Find my school'
- Type in Wasatch
- At the bottom click 'Create Account'
- Create an account using the pairing code your student generated (see above)



 If you have a **@wasatch.edu email address** you will not be able to use that email to be an observer. A parent account creates different access rights than a teacher/administrator account and therefore the observer option isn't available. So, you will need to create a different account following the instructions above.

If you already have a parent account here is the link for the instructions to add your student to your account.

Log into Canvas and open user settings

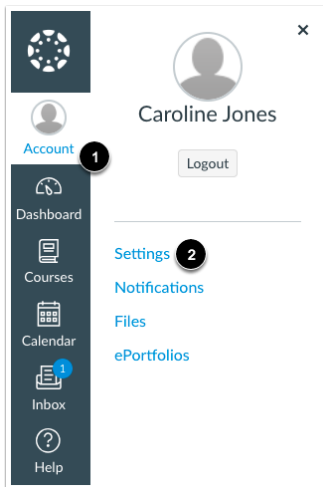

In Global Navigation, click the **Account** link [1], then click the **Settings** link [2].

Open Observing

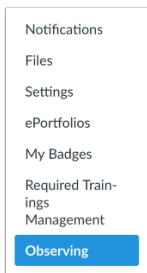

In User Navigation, click the **Observing** link.

Add Student

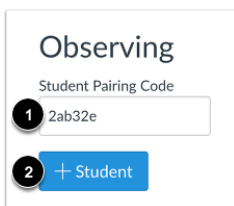

Type the pairing code in the **Student Pairing Code** field [1] and click the **Add Student** button [2].

View Student

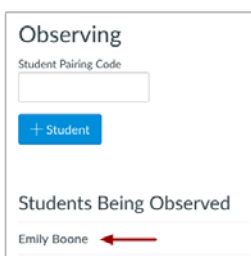

View the paired student.